

Fairline Mirage MK I





Fairline Mirage MK I

A 29' offshore motor cruiser that really combines luxury with seaworthiness and performance – at a realistic price. Designed by John Bennett A.R.I.N.A. and the Fairline design team, the seakindly hull gives all weather performance, and the spacious layout allows five full length berths in two cabins – to provide luxurious accommodation for all the family.

Constructed of glassfibre throughout and manufactured to Fairlines high standards, the Mirage comes complete with a most comprehensive inventory that has everything required for a comfortable life afloat.

Hull Form and Construction

A deep 'V' hull fares into the keel to give a soft entry into choppy head seas, and the keel improves directional stability at low speeds – as well as reducing crosswind drift. The aft end of the hull is of a rounded section to obtain maximum bouyancy and uplift with minimum wetted area – for easy economical planing performance.

All glassfibre throughout the boat is laid up by hand, doubled on the chines and in all high stress areas and incorporating woven and unidirectional rovings where appropriate. No fillers are used; hull and deck are bolted and bonded together with deck and waterline colours moulded in.

Deck Fittings

Anchor and chocks; bow locker; anchor hawse pipe; anodised alloy bow, spring and stern cleats, and fairleads, stemhead roller; pulpit, pushpit, coachroof and helm shelter grab rails. Navigation lights, double life lines with anodised alloy stanchions; anodised alloy rubbing strake with plastic fender section insert; chromed brass fuel and water fillers. Cockpit hood with opening section over helmsman and co-pilot. Riding light; horn; moulded non slip deck surface. Fender holders on pulpit.

Cockpit

Teak/G.R.P. Engine and fuel tank hatches; Aft cockpit seat converts to Sun Bed with storage under; storage for twin gas bottles and gear under side decks and outboard of engine(s); Chart table built into cabin hatch; Toughened sundim glass helm shelter windows framed in anodised alloy with opening side panels; deluxe helm seat adjustable vertically and fore and aft; self draining vents fore and aft.

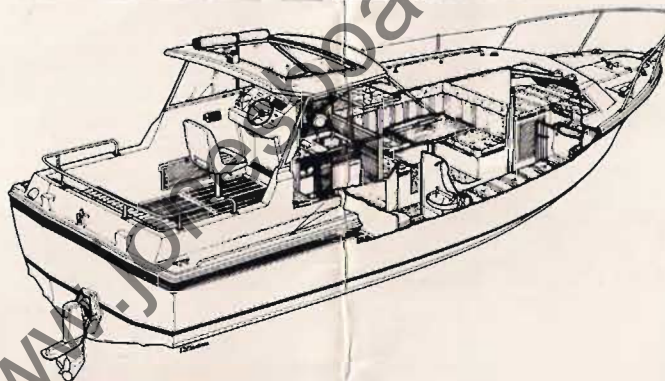
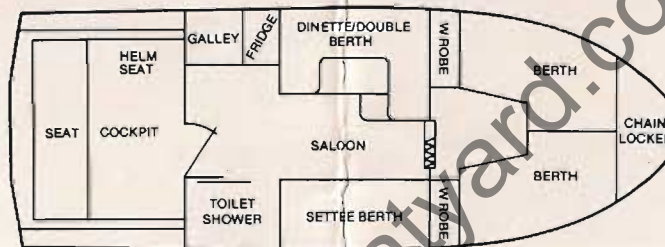

Instruments and Controls

Compass (not swung), Echosounder; full engine instrumentation including tachometer(s), engine hour meter, battery state indicator, water temperature gauge(s), cigarette lighter; starter battery changeover switch (twin engine boats). Twin windscreen wipers.

Engines, Electrics, Fuel and Gas

112 gallon stainless steel fuel tank under removable hatch in forward part of cockpit; electrical fuel gauge; copper feed lines to engines; reinforced aircraft quality fuel filler and bleed pipes; fuel tank bay separated by full bulkheads from engine compartment and aft cabin. 8-way electrical fuse system; 2 x 127 a.h. batteries (diesel boats); 1 x 50 a.h. and 1 x 110 a.h. batteries (petrol boats); battery and domestic services isolating switches; electrical bilge pump; exhaust blower in engine bay (petrol engine boats only); hinged cockpit floor hatch for easy access to

engine(s); crytic fire retardant resin on all surfaces. Stowage for twin gas bottles connected by copper pipe to cooker (stowage box vented overboard and made of fire retardant resin). Twin engine boats have 1 x 127 a.h. extra battery (diesel); 1 x 50 a.h. extra (petrol).

Internal Accommodation

All woodwork in teak and/or afromosia. Anodised alloy framed opening windows glazed in shatterproof 6 mm Plexiglass.

Separate forward cabin with two 6' 6" x 2' 3" single berths, wardrobe, hatch to foredeck, ventilators, carpets, curtains, shelving, etc. Large lockers under both berths, mirror, berth lights, bookshelves.

Aft Cabin with 4' 2" x 6' 5" double dinette berth and single 2' 3" x 6' 5" berth opposite. Wardrobe, lockers under all berths, two cabin lights, carpets and curtains throughout.

Galley with refrigerator; oven, two burner cooker with grill; stainless steel sink; automatic pressure hot and cold water; formica work top; plate and cup stowage; fire extinguisher.

Toilet Sea toilet (or chemical toilet to choice). Seacocks on toilet outlet and inlet. Electric shaver point. Wash basin and shower. Vanity Unit. Hot and Cold water; automatic electric shower pump out. Towel holder, toilet roll holder, toothbrush holder, etc. Ventilating window.

Principal Dimensions

L.O.A. (excl. Outdrive)	28' 5 1/2" (excl. outdrive) (8.67m)
Beam	10' 1 1/2" (3.09m)
Height above W.L.	8' 5" (2.56) (can be reduced to 8' 3" if necessary)

Draught (Outdrive up)	2'0" (.61m)
Dry Weight (2 140/280)	C. 3300kg
Fuel Capacity	112 gallons (510 L)
Water Capacity	52 gallons (236 L)
Cabin Headroom	6' 3" (6' 1" in toilet)

Approximate Performance

1 x 145/280 Volvo – 12 knots	1 x AD40/280 – 21 knots
1 x 200/280 Volvo – 22 knots	2 x 120/270 Volvo – 24 knots
1 x 225/280 Volvo – 24 knots	2 x 145/280 Volvo – 28 knots
1 x D21/280 Volvo – 8 knots	2 x D21/280 Volvo – 12 knots

Performance estimates are given in good faith but are in no way guaranteed for any particular boat. Dirt on the bottom of the boat, damage to the propellor, engine tuning and the weight of fuel and stores carried can all adversely affect performance, and for these reasons we can give no performance guarantees. This specification may be changed at any time without notice. The boats illustrated have certain optional extras in some cases, and do not always conform to the standard specification.