

[www.jonesboatyard.co.uk](http://www.jonesboatyard.co.uk)

*Freeman 750*



# FREEMAN 750

## STANDARD LAYOUT

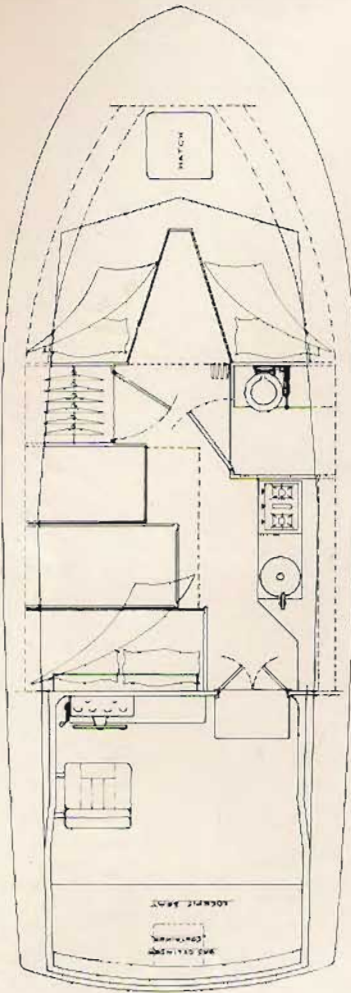

## Capacities and Dimensions

Length	24' 6" (7.466 m)
Beam	9' 0" (2.743 m)
Draft (aft)	2' 0" (0.610 m)
Headroom cabin	6' 1" (1.854 m)
Height above waterline	7' 6" (2.286 m)
Fuel capacity	15 gallons (68.19 litres)
Water capacity	15 gallons (68.19 litres)

### EXTERIOR

Stainless Steel Pulpit, Cleats fore and aft, Fairleads, Stainless Steel handrails on cabin roof, hard top roof and aft hard top handrail supports, Anti slip deck, Mast, Wrap-around fendering, Flag pole socket

### GALLEY

Gas grill and two burners, Stainless Steel sink, Food storage, Crockery locker, Folding work surface, Electric water pump (see extras for H & C Options)

### COCKPIT AND HELM POSITION

Easy clean cockpit flooring, Stainless Steel pushpit, Vented calor gas container, Leather cloth finish behind screen and crash pad, Helm Seat, Instrument panel, Stainless steel wheel, Access to all electrics and fuses, Single lever control, Stowage below floor, Helmsman footrest, Cockpit cover

### INTERIOR

Sandwich construction superstructure, lined ceiling and side walls, 2 Single berths with book shelves above and stowage below, Escape hatch in fore deck, Wardrobe, Curtain partition, Dinette double berth with chest of drawers below and blanket locker

### TOILET

Chemical toilet (Sea toilet option), Vanity unit (option) with H & C Water (option)

### ELECTRICAL

Windscreen wiper, Full navigation lights, Battery cut-off switch, Cabin lighting, Full engine instrumentation, Heavy duty battery, Fridge (option), Provision for horn

### UNDERWATER GEAR

All underwater gear is constructed in Manganese bronze, including all bolts and nuts.

### ENGINE OPTIONS

See Price List

### OPTIONAL EXTRAS

See Extras List

## OUTDRIVE LAYOUT

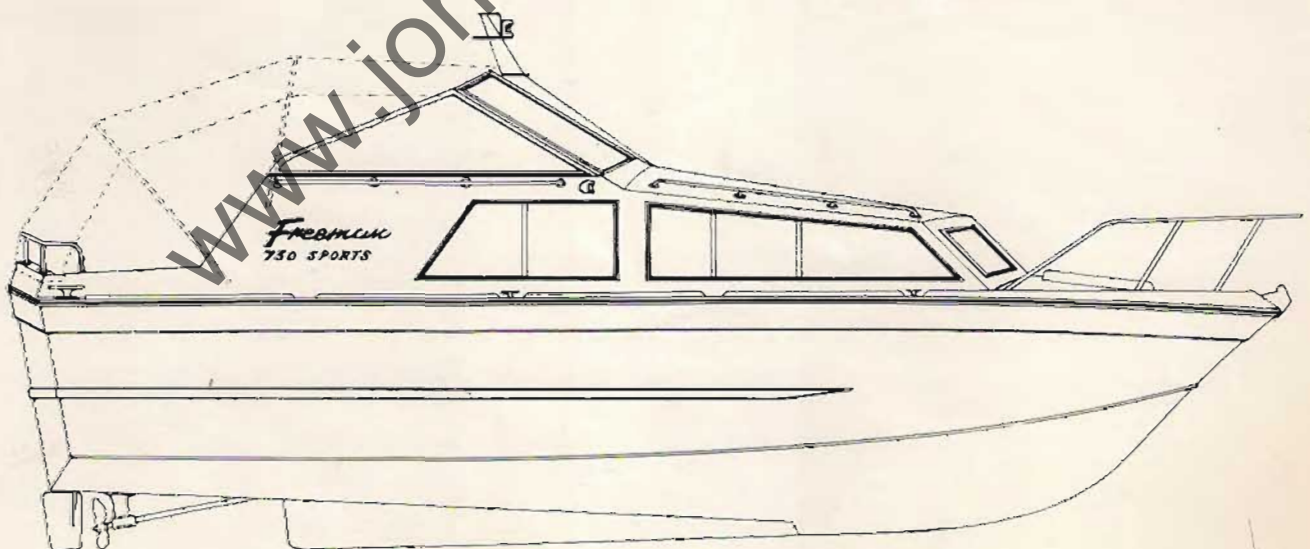
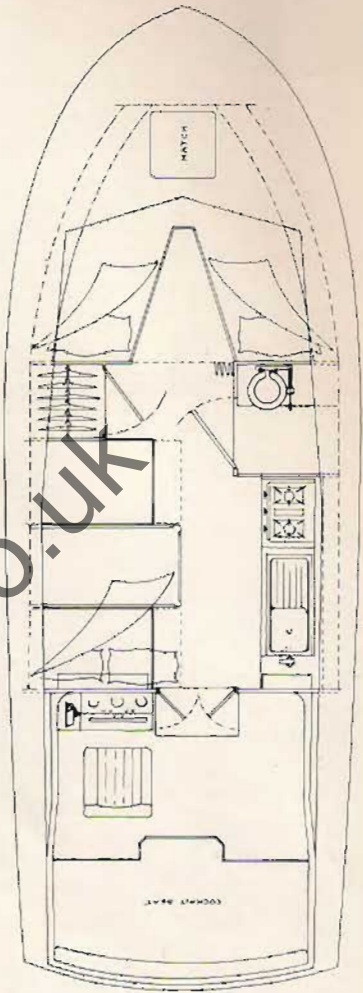

## FREEMAN 750 SPORT

*We reserve the right to make alterations to the specifications and prices which from time to time may be considered necessary, without notification.*

# JOHN FREEMAN (MARINE) LTD.

WOLVEY, NEAR HINCKLEY, LEICESTERSHIRE, ENGLAND 0455 220527 FOUR LINES TELEX 342184