



www.jonesboatyard.co.uk

Viking







# VIKING MOULDINGS

Unit 11, Ongar Road Trading Estate  
Dunmow, Essex CM6 1EU  
Telephone: Great Dunmow (0371) 875214  
Fax: (0371) 873826

## Viking 20



### • STANDARD FITTINGS •

- Canopy
- Screen
- Pulpit
- Cushions
- Curtains
- Grill with fire resistant surround
- Teak-faced interior finishes
- Mechanical steering complete with wheel
- Covered head-lining
- Foredeck hatch
- Cabin floor carpeted
- Sink and drainer
- Table

- 1. Single Berth (converts to double)
- 2. Seats
- 3. Table - forms double berth
- 4. Toilet compartment
- 5. Grill
- 6. Sink and drainer
- 7. Bench seat
- 8. Engine well
- 9. Storage space

Length	20'
Beam	7' 4"
Weight (excl. engine)	815 kg approx.
Draught	1' 2"
Height above waterline	6' 6"
Headroom in cabin	approx. 6'
Berths	4
Hull shape	Displacement
Construction	GRP
Maximum outboard rating	40hp
Outboard type	Long shaft

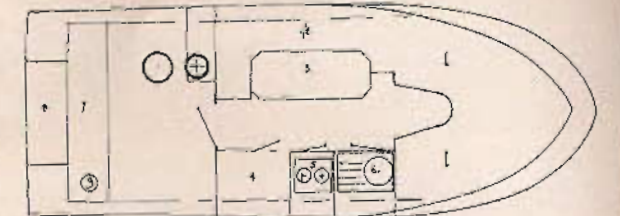

Available in Kit Form (Hull, Superstructure and Interior)

## Viking 23



### • STANDARD FITTINGS •

- Canopy
- Screen
- Pulpit
- Cushions
- Curtains
- Cooker with fire resistant surround
- Mechanical steering complete with wheel
- Cabin floor carpeted
- Handrails
- 1. Bow eye
- 3. Cleats
- 2. Fairleads
- Fender eyes
- Hot and cold Water System

- 5. Cooker
- 6. Sink and drainer
- 7. Drawer Space
- 8. Wardrobe
- 9. Fridge space
- 10. Back seat
- 11. Engine well

Length	23' 00"
Beam	6' 10"
Weight (excl. engine)	1000 kg approx.
Draught	1' 2"
Height above waterline	6' 6"
Headroom in cabin	approx. 6'
Berths	4
Hull shape	Displacement
Construction	GRP
Maximum outboard rating	40hp
Outboard type	Long shaft

- 1. Single Berth (converts to double)
- 2. Seats
- 3. Table - forms double berth
- 4. Shower & Toilet compartment

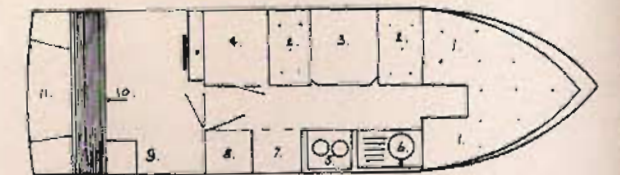

ILLUSTRATIONS ARE ONLY REPRESENTATIVE OF OUR CRAFT WHICH MAY VARY. SPECIFICATIONS ARE LIABLE TO CHANGE.





# VIKING MOULDINGS

Unit 11, Ongar Road Trading Estate  
Dunmow, Essex CM6 1EU  
Telephone: Great Dunmow (0371) 875214  
Fax: (0371) 873826

## Viking 22/91



- Canopy
- Screen
- Pulpit – Cockpit rail
- Cushions
- Curtains
- Two burner grill with fire resistant surround
- Mechanical steering and wheel
- Cabin floor carpeted
- Handrails
- 1 Bow Eye
- 3 Cleats
- 2 Fairleads
- Fender eyes
- Hot/cold shower
- Opening hatch

1. Single Berth (converts to double)
2. Table
3. Sink and drainer
4. Hob/Grill

### • STANDARD FITTINGS •

5. Top with Drawers under
6. Wardrobe
7. Toilet/Shower
8. Step into Cabin
9. Double Berth under cockpit floor, storage behind
10. Double Bench Helm Seat
11. Locker space under back seat
12. Outboard well

Length	22'
Beam	7' 8"
Draught	1' 4"
Weight (excl. engine)	1,000 kg approx.
Height above waterline	7' 8"
Headroom in cabin	6' approx.
Berths	4
Hull shape	Med Vee
Construction	GRP
Maximum outboard rating	140hp
Outboard type	Long shaft

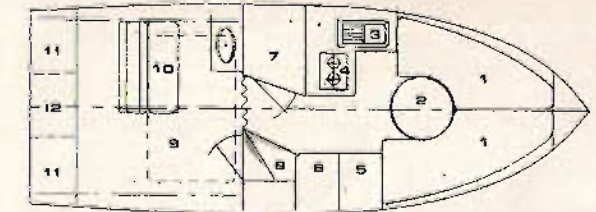

Available in Kit Form (Hull, Superstructure and Interior)

## Viking 26

WIDE BEAM



- Canopy
- Screen
- Pulpit – pushpit
- Cushions
- Curtains
- Opening escape window
- Cooker with fire resistant surround
- Mechanical steering and wheel
- Cabin floor carpeted
- Handrails forward cabin
- 1 Bow Eye
- 3 Cleats
- 2 Fairleads
- Fender eyes
- Hot & cold shower
- Complete hot & cold water system

1. Double Berth
2. Shelf
3. Wardrobe
4. Sink and drainer

### • STANDARD FITTINGS •

5. Cooker
6. Cupboard
7. Steps into Cabin
8. Dinette with storage under
9. Toilet/Shower
10. Double berth under cockpit
11. Bench Helm Seat
12. Outboard well
13. Back seat with locker space under

Length	26'
Beam	9'
Weight	2100 kg approx.
Draught	1' 6"
Height above waterline (Screen up)	7' 3"
Headroom in forward cabin	6' 2" approx.
Berths	6
Hull shape	Displacement
Construction	GRP
Maximum outboard rating	80hp

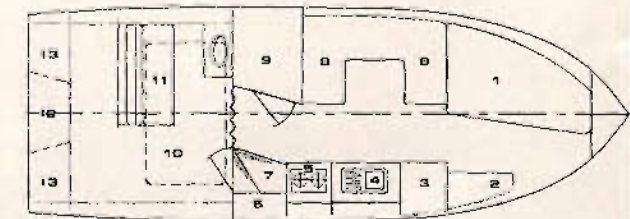





# VIKING MOULDINGS

Unit 11, Ongar Road Trading Estate  
Dunmow, Essex CM6 1EU  
Telephone: Great Dunmow (0371) 875214  
Fax: (0371) 873826

## Viking 26

6 BERTHS, CENTRE COCKPIT



### • STANDARD FITTINGS •

- Canopy
- Screen folding
- Pulpit
- Cushions
- Curtains
- Opening hatch
- Cooker with fire resistant surround
- 1 Bow Eye
- 5 Cleats
- 2 Fairleads
- Fender eyes
- Hot & cold shower
- Complete hot & cold water system forward & aft cabins
- Mechanical steering and wheel
- Cabin floor carpeted
- Handrails forward & aft cabins

- 1. Single Berth (converts to double)
- 2. Seats
- 3. Table - forms double berth

- 4. Shower and toilet compartment
- 5. Cooker
- 6. Sink and drainer
- 7. Fridge space
- 8. Wardrobes
- 9. Single berth (can convert to double)
- 10. Basin & storage space
- 11. Engine well & shelf

- Length 25' 8"
- Beam 6' 10"
- Weight (excl. engine) 1500 kg approx.
- Draught - 1' 2" Height above waterline 6' 8"
- Headroom in forward cabin approx. 6' 2"
- Headroom in after cabin approx. 5' 10"
- Berths 6
- Hull shape Displacement
- Construction GRP
- Maximum outboard rating 50hp
- Outboard type Long shaft  
(Inboard version available)

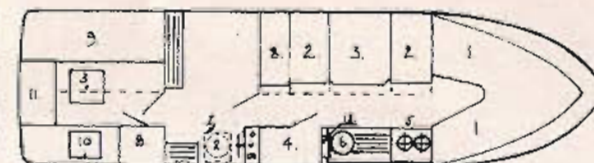

Available in Kit Form (Hull, Superstructure and Interior)

## Viking 26

6 BERTHS, AFT COCKPIT



### • STANDARD FITTINGS •

- Canopy
- Screen folding
- Pulpit
- Cushions
- Curtains
- Opening hatch
- Cooker with fire resistant surround
- Mechanical steering and wheel
- Cabin floor carpeted
- Handrails forward cabin
- 1 Bow eye
- 3 Cleats
- 2 Fairleads
- Fender eyes
- Hot & cold shower
- Complete hot & cold water system

- 1. Single Berth (converts to double)
- 2. Seats
- 3. Table (forms double berth)
- 4. Shower & Toilet compartment

- 5. Cooker
- 6. Sink & drainer
- 7. Fridge space
- 8. Wardrobes
- 9. Single berth (converts to double)
- 10. Engine well & shelf
- 11. Water heater
- 12. Hatch

- Length 25' 8"
- Beam 6' 10"
- Weight (excl. engine) 1500 kg approx.
- Draught - 1' 2" Height above waterline 6' 8"
- Headroom in forward cabin approx. 6' 2"
- Headroom in after cabin 5' 10"
- Berths 6
- Hull shape Displacement
- Construction GRP
- Maximum outboard rating 50hp
- Outboard type Long shaft  
(Inboard version available)

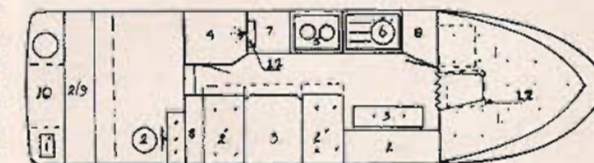





# VIKING MOULDINGS

Unit 11, Ongar Road Trading Estate  
Dunmow, Essex CM6 1EU  
Telephone: Great Dunmow (0371) 875214  
Fax: (0371) 873826

## Viking 22



### • STANDARD FITTINGS •

Canopy  
Screen  
Pulpit - Cockpit rail  
Cushions  
Curtains  
Two burner grill with fire resistant surround  
Mechanical steering and wheel  
Cabin floor carpeted  
Handrails  
1 Bow Eye  
3 Cleats  
2 Fairleads  
Fender eyes  
Electric pump Cold water  
Opening hatch

1. Single Berth (converts to double)
2. Seats
3. Table - forms double berth

4. Toilet compartment
5. Grill
6. Sink and drainer
7. Fridge space under Helm seat
8. Wardrobe & cupboard
9. Helm seat with fridge below
10. Back seat
11. Engine well

Length 22'  
Beam 7' 8"  
Weight (excl. engine) 900 kg approx.  
Draught 1' 4"  
Height above waterline 6' 6"  
Headroom in cabin approx. 6'  
Berths 4 + 1  
Hull shape Med Vee  
Construction GRP  
Maximum outboard rating 140hp  
Outboard type Long shaft

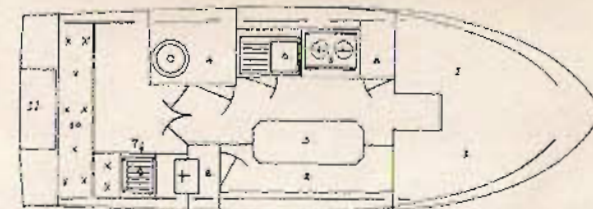

Available in Kit Form (Hull, Superstructure and Interior)

## Viking 32



### • STANDARD FITTINGS •

Canopy  
Screen folding  
Pulpit and pushpit  
Cushions  
Curtains  
Opening hatch  
Cooker with fire resistant surround  
1 Bow eye  
4 Cleats  
2 Fairleads  
Fender eyes  
Hot & cold shower  
Complete hot & cold water system  
(Forward & aft cabins)  
Mechanical steering and wheel  
Cabin floor carpeted  
Handrails forward and aft cabin  
Fridge

1. Single Berth (converts to double)
2. Toilet compartment
3. Seats
4. Table (converts to double)
5. Hand basin, drawers under

6. Cooker
7. Sink & drainer
8. Fridge
9. Wardrobe
10. Single berths
11. Shower & Toilet
12. Double berth
13. Outboard well

Length 32'  
Beam 6' 10"  
Weight (excl. engine) 2100 kg approx.  
Draught 1' 4"  
Height above waterline 5' 10"  
(with screen folded)  
Headroom in forward cabin approx. 6' 2"  
Headroom in after cabin approx. 5' 10"  
Berths 6 + 2  
Hull shape Displacement  
Construction GRP  
Maximum outboard rating 50hp  
Outboard type Long shaft  
(Inboard version available)

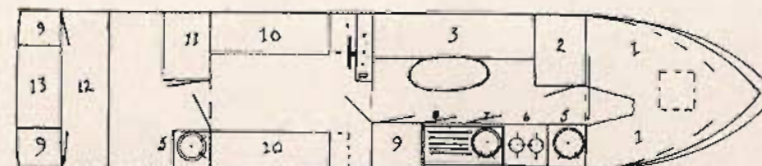





# VIKING MOULDINGS

Unit 11, Ongar Road Trading Estate  
Dunmow, Essex CM6 1EU  
Telephone: Great Dunmow (0371) 875214  
Fax: (0371) 873826

## Viking 28



### • STANDARD FITTINGS •

- |                                      |  |
|--------------------------------------|--|
| Canopy                               | 8. Wardrobes   |
| Screen                               | 9. Steps into cabin                                  |
| Pulpit - Pushpit                     | 10. Dinette } converts to Double Berth               |
| Cushions                             | 11. Table }  |
| Curtains                             | 12. Toilet   |
| Opening hatch                        | 13. Double Berth under cockpit floor, storage behind |
| Cooker with fire resistant surround  | 14. Double bench Helm seat                           |
| Mechanical steering and wheel        | 15. Bench seat                                       |
| Cabin floor carpeted                 | 16. Storage space                                    |
| Handrails forward cabin              | 17. Outboard well                                    |
| 1 Bow eye                            | 18. Folding door                                     |
| 3 Cleats                             | Length 28'   |
| 2 Fairleads                          | Beam 6' 10"  |
| Fender eyes                          | Weight (excl. engine) 1800 kg approx.                |
| Hot & cold shower                    | Draught 1' 4"  |
| Complete hot & cold water system     | Height above waterline (screen folded) 6'            |
| 1. Single Berth (converts to double) | Headroom in main cabin 6' 1" approx.                 |
| 2. Washbasin with drawer under       | Berths 6   |
| 3. Table and infill                  | Hull shape Displacement                              |
| 4. Worktop, cupboard under           | Construction GRP                                     |
| 5. Worktop, drawers under            | Maximum outboard rating 50hp                         |
| 6. Cooker with top cover             | Outboard type Long shaft                             |
| 7. Sink and drainer                  |  |

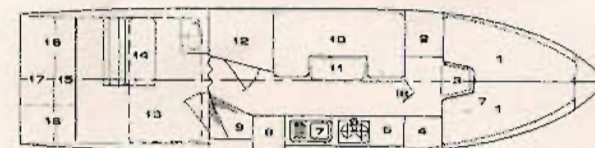

Available in Kit Form (Hull, Superstructure and Interior)



# VIKING MOULDINGS

Unit 11, Ongar Road Trading Estate  
Dunmow, Essex CM6 1EU  
Telephone: Great Dunmow (0371) 875214  
Fax: (0371) 873826

