



We are on Lloyd's Approved List of Reinforced Plastic Boatbuilders and Moulders

# ELYSIAN

## 27 AND 34

These new 27 ft. Glass Fibre Chine Cruisers have been designed by our development team after years of experience as high-class wooden boat constructors and hire fleet operators. Through this experience we have found that Glass Fibre Hulls—properly manufactured under the most stringent conditions—cannot be surpassed for rugged strength and ease of maintenance combined with light overall weight, this being an important factor for the owner/user. Repairs are simplicity itself, although very rarely necessary, and the use of standard pigmentation of the resin eliminates the problem of colour matching.

Since introducing these models we have incorporated many improvements which have been gained through past experience together with suggestions made by present users of our craft. The workmanship and materials of the interior fittings are true to the boatbuilding tradition, and the utmost care has been taken when fitting out, to use all available space to the best advantage.

The Saloon during the day presents a roomy, spacious cabin complete with ample storage space, and full-length wardrobe, whilst at night it readily converts to a double state-room. Completely separated from the forward cabin, the latter offering not only sleeping accommodation but dressing table and considerable storage space, with wash hand basin and a removable hatch to fore-deck.

The interior is lined throughout to give a smooth surface for easy cleaning: interior panelling harmonising with the upholstery. The large windows ensure maximum light, with controlled ventilation and excellent viewing.

Interior lighting is supplied as standard, running off 12-volt battery as used on the electric starting and ignition systems of the engines.

Positive and light Teleflex steering is situated in the large aft cockpit with all controls to hand, together with fuel, fresh water tanks and gas supply. There is ample storage accommodation for gear, and the large stern bench seat can easily be adapted to form an additional berth.

Both twin-screw and single-screw versions of this model are available powered by diesel or petrol engines and performance is dependent on weight and dimensions of engine installation.

Either craft is suitable for family cruising, with ample space for sun-bathing or for fishing from the spacious cockpit. The fitted windscreen is specially designed to give adequate protection to the helmsman without impeding the view, and a canopy can be fitted to the standard windscreen to give complete weather protection.

Whilst the standard single screw craft is most suitable for private owners who wish to get afloat for a reasonable capital outlay we are now producing a model from the same moulding with a modified lay-out, incorporating a different keel design, a larger toilet compartment with wash hand basin and increased fresh water storage.

This new model has been designed to meet the requirements of hire fleet operators, and has proved very successful in our own Fleet.



### Dimensions

Length overall—27 ft.

Beam—9 ft. 6 in. (2.9 m)

Draft—1 ft. 10 in. (0.58 m)

### Materials

Laminated from the finest resins with an exceptional strength guaranteed to be free from defects.

The finished product is resistant to marine borers, salt water attack. The moulding process eliminates the necessity for annual painting.

### Engines—Single Screw

Powered by Newage engines, standard.

### Engines—Twin Screw

Powered by twin Perseus engines, 48 b.h.p. at 4,000 r.p.m. 1½ gallons (7.5 litres) fuel tank. speeds of 15 knots.

Other types of engines can be installed depending on requirements.





Assembly Shop



Elysian 27 Standard Single Screw Model



### Dimensions

Length overall—27 ft. (8.2 m).  
Beam—9 ft. 6 in. (2.9 m).  
Draft—1 ft. 10 in. (0.56 m).

### Materials

Laminated from the finest glass reinforcement and polyester resins with an exceptionally high glass/resin ratio, and guaranteed to be free from additives, i.e. fillers or alkali glass.

The finished product is impervious to climatic extremes and marine borers, similarly rot, corrosion and galvanic attack. The moulding colour is pigmented thus avoiding the necessity for annual repainting.

### Engines—Single Screw Model

Powered by Newage/B.M.C. Vedette petrol engine as standard.

### Engines—Twin Screw Model

Powered by twin Perkins Diesel 4/107 engines, developing 48 b.h.p. at 4,000 r.p.m. each with a fuel consumption of  $1\frac{1}{2}$  gallons (7.5 litres) per hour direct drive giving practical speeds of 15 knots.

**Other types of engines**, either petrol or diesel, can be installed depending on overall dimensions and weight.

### Installation

Engines are flexibly mounted in sound insulated cases and each engine is fitted with its own 25 gallon fuel tank: stern gear is manganese bronze with stainless steel tailshaft: electric starting and lighting from a standard 12 volt battery, butane gas storage to safety regulations.

### Standard Specification

Opening windows in all cabins; carpet on cabin floors; curtain fittings; full length convertible dinette and other berths with 4 in. vinyl covered polyfoam cushions; complete interior electric lighting; hotplate and grill; stainless steel sink with high pressure laminate surround; wash basin in forward cabin; towel rail, toilet fittings and mirror; chemical toilet; signal mast; navigation and cockpit lights; alloy handrails on cabin top; electric horn and all deck fittings chromium plated; mooring ropes and four 8 in.  $\times$  4 in. Coir fenders.

We reserve the right to amend the specification to take advantage of advances in design and construction at any time without prior notice.

**Trade Enquiries** are invited for special terms for the supply of Hulls, Superstructures and completed craft. Appointments may be made to visit our Works to view the craft in course of construction.

### 1965 annou

### Dimension

Length ov  
Moulded  
Draft (at 4

Trade er  
accepted fo  
moulded Hu

The ELYS  
ways cruise  
operators a  
gained in fit  
be possible  
standard lay  
to complete  
lowest poss  
war years.

Write and

**APP  
& CO**



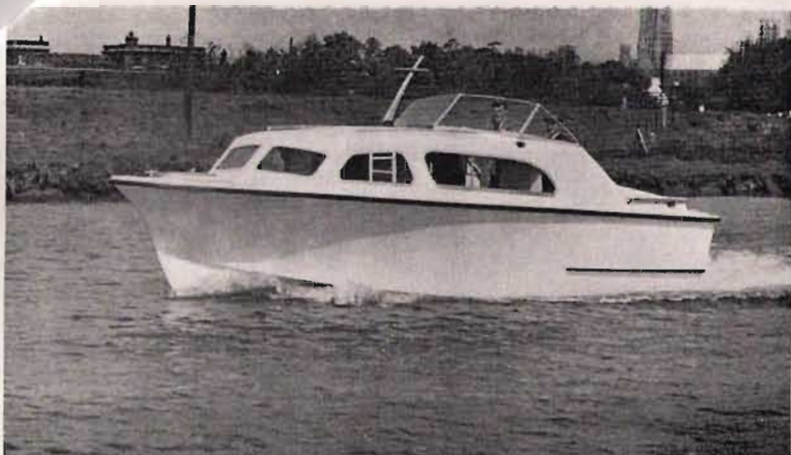

Elysian 27 Standard Single Screw Model



Elysian 27 Standard Twin Screw Model

### Installation

Engines are flexibly mounted in sound insulated cases and each engine is fitted with its own 25 gallon fuel tank; stern gear is manganese bronze with stainless steel tailshaft; electric starting and lighting from a standard 12 volt battery, butane gas storage to safety regulations.

### Standard Specification

Opening windows in all cabins; carpet on cabin floors; curtain fittings; full length convertible dinette and other berths with 4 in. vinyl covered polyfoam cushions; complete interior electric lighting; hotplate and grill; stainless steel sink with high pressure laminate surround; wash basin in forward cabin; towel rail, toilet fittings and mirror; chemical toilet; signal mast; navigation and cockpit lights; alloy handrails on cabin top; electric horn and all deck fittings chromium plated; mooring ropes and four 8 in. x 4 in. Coir fenders.

We reserve the right to amend the specification to take advantage of advances in design and construction at any time without prior notice.

**Trade Enquiries** are invited for special terms for the supply of Hulls, Superstructures and completed craft. Appointments may be made to visit our Works to view the craft in course of construction.

### 1965 announces our Elysian 34

#### Dimensions

Length overall—34 ft. 6 in. (10.53 m).

Moulded Beam—10 ft. 4 in. (3.15 m).

Draft (at 4 tons displacement) 2ft. 3 in. (0.68 m).

Trade enquiries invited for our new model. Orders accepted for moulded Hulls only for 1965 season, and moulded Hulls and Superstructures for 1966 season.

The ELYSIAN 34 is a round bilge glass fibre inland waterways cruiser designed to meet the requirements of hire fleet operators as well as private owners. From the experience gained in fitting out these hulls for the coming season it will be possible to design a moulded superstructure for the best standard layout. This will enable the boatbuilding industry to complete the most modern 4 to 6 berth cruiser for the lowest possible capital outlay for a craft in its class in post war years.

Write and make an appointment to view at our works.

# APPLEYARD, LINCOLN & CO [Boatbuilders] LTD



# 34

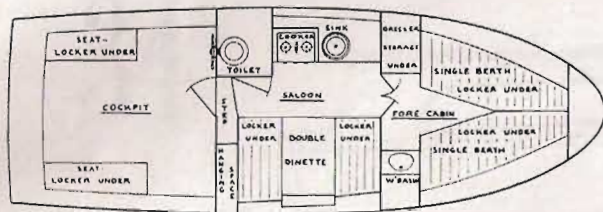

## Alternative-Layout

Type B Standard Craft—Settee Berth

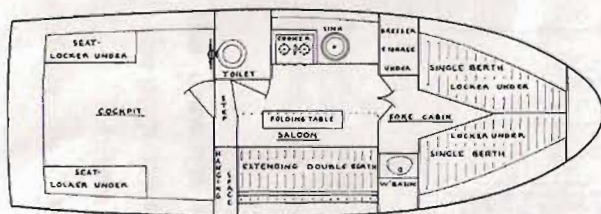

Type C

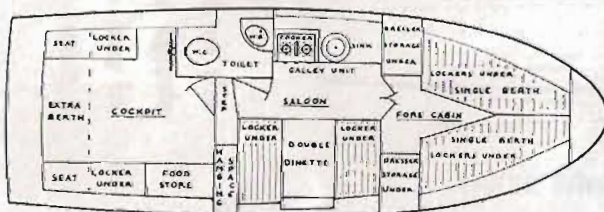

This new lay-out provides more storage space, larger toilet compartment with wash hand basin and increased fresh water storage; special keel for easy hauling out and additional full length reinforced rubbing beads on hull.

This model is particularly recommended for Hire Fleet Operators.

Copyright in the drawings and the hull of the ELYSIAN 34 is the property of Appleyard, Lincoln & Co. (Boatbuilders) Limited, and neither may be reproduced without their written permission.

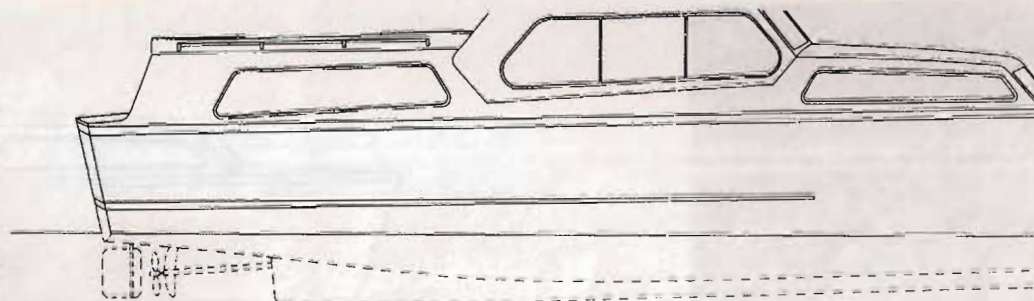

General Arrangement

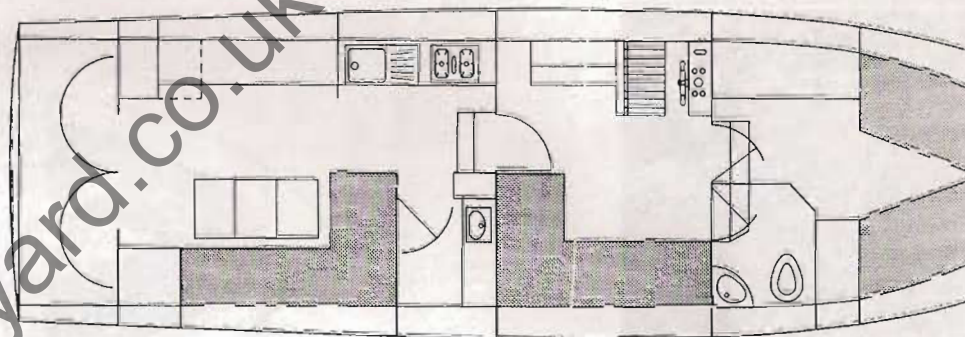

Lines drawing

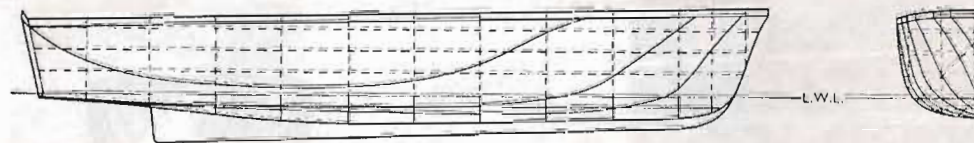

THESE FINE CRAFT ARE BUILT FOR YOUR PLEASURE BY

# APPLEYARD, LINCOLN & CO [Boatbuilders]

RIVERSIDE BOATYARD, ELY, CAMBRIDGESHIRE / TELEPHONE

DEAL WITH A



FEDERATED FIRM

W. Heffer & Sons Ltd., Cambridge, England.



# 34

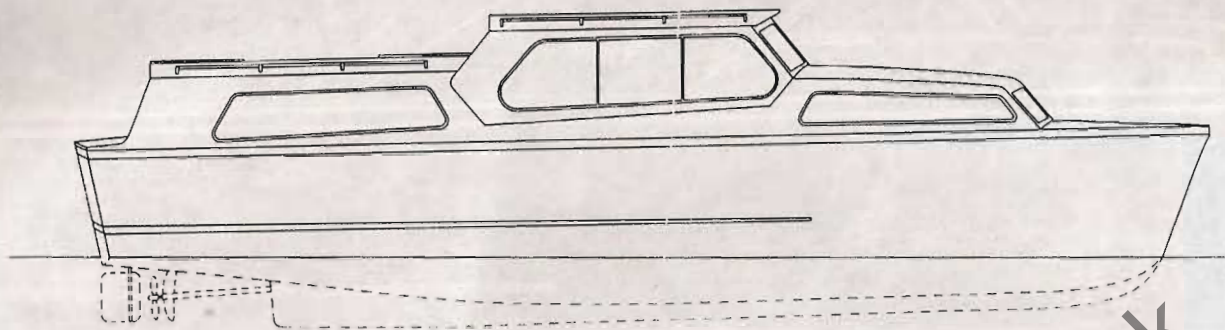

General Arrangement

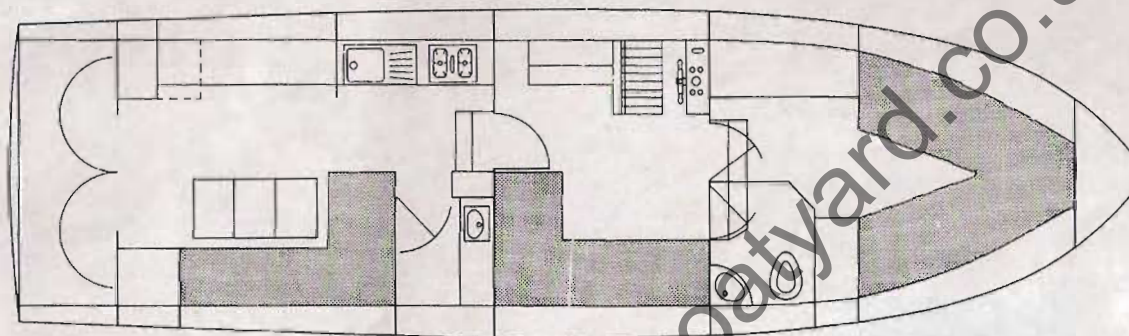

Lines drawing

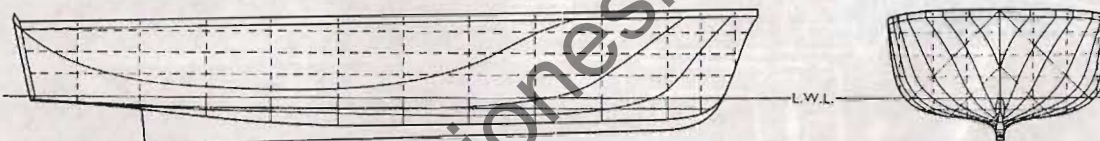

THESE FINE CRAFT ARE BUILT FOR YOUR PLEASURE BY

## APPLEYARD, LINCOLN & CO [Boatbuilders] LTD

RIVERSIDE BOATYARD, ELY, CAMBRIDGESHIRE / TELEPHONE: ELY 2244/5

DEAL WITH A



FEDERATED FIRM

W. Heffer & Sons Ltd., Cambridge, England.

Copyright in the drawings and the hull of the ELYSIAN 34 is the property of Appleyard, Lincoln & Co. (Boatbuilders) Limited, and neither may be reproduced without their written permission.

arger  
ased  
and

Fleet