

# The *New* Viking 20 Mk.2

Re-styled

Four Berth Family Cruiser



# Viking

# Mouldings



# The Viking 20

## The Four Berth

Read that headline again! Yes the Viking 20 really has everything you could ask for in a four berth cabin cruiser at this price. Now that isn't just sales talk, we really mean it — and Boat Magazine, who in May 1978 tested one of our prototypes, agree. That test was carried out *before* we did our latest modifications! "Viking Mouldings offer a lot of boat for your money" and "she is a sensibly laid out and strongly built boat" — that's what 'Boat' said about the Viking 20.



Built by craftsmen, it offers the ideal holiday home afloat for four adults, and the latest model is an enormous improvement on earlier ones. It still has full standing-headroom throughout and adjustments have been made to handling capacity making it more stable than ever, even offshore.

To the best of our knowledge, with all the latest modifications, there's no other boat quite like the Viking 20 in the twenty foot range.

The emphasis in the entire craft is on comfort and roominess with thoughtful planning, enabling it to accommodate four adults. Cabin layout has been designed to include all the essentials such as, four sensibly sized berths, dinette, seats, table, separate toilet compartment, a hanging locker, cooker, stainless steel sink storage space and cupboards.



The sleeping arrangements are such that there are now two double berths or two single and one double, the latter converting into a 'mini-diner', consisting of four adult seats around a good size table. A well appointed galley has adequate facilities, with sink, drainer and gas cooker with grill and oven. The cooker is completely plumbed in, with gas supply storage in the cockpit.

The cabin is designed for maximum freedom of movement, and the feeling of roominess is something you'll comment on the moment you step inside. There is an abundance of locker space, and the toilet now has a single locking door, instead of the original folding style.

One of the most striking features of this boat is the touch of luxury which is on all models, even the standard one. The cabin roof is generously lined with a headlining that reaches down to the floor with its wall-to-wall carpeting. The interior, bulkhead and toilet are lavishly finished in teak faced ply. These items are not generally available on standard models, they usually come only as extras. Comfortable, thick fabric upholstered cushioning is used for the seats, which certainly add to the boat's overall feeling of quality.



# h Cruiser that has simply EVERYTHING!

## Specification

Available in kit form (hull, super-structure and interior).

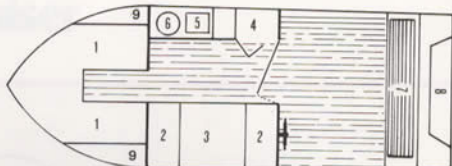

### STANDARD FITTINGS\*

Length	20'
Beam	7'4"
Weight (excl. engine)	750kg (appx 1742lbs)
Draught -14" Height above water line	7'6"
Headroom in cabin	6'
Berths	4
Hull shape	Displacement
Construction	GRP
Maximum outboard rating	40hp
Outboard type	Long shaft

Teak-faced ply interior finishes  
 Mechanical steering  
 complete with wheel  
 Vinyl covered head-lining  
 Foredeck hatch  
 Cabin floor carpeted  
 Stainless steel sink and  
 drainer  
 Table

1. Single Berth (can be converted to double)
2. Seats
3. Table forms double berth
4. Toilet
5. Cooker space
6. Stainless Steel Sink
7. Bench seat
8. Engine Well
9. Storage space

Panels in matching material to the headlining are also to be found in the cockpit as is the wall-to-wall carpeting which is fitted around the large teak covered helm console. From the helm seat, which is mounted on a raised plinth, a good view of the controls and overall visibility is ensured.

The glass-fibre hull and the super-structure are built for maximum internal volume, and while the Viking is not meant to be a really fast boat it is particularly suited to cruising in rivers, canals, broads, inland waterways and even offshore.

Latest modifications have been made to enable this craft to be used with either inboard or outboard engine, including cable driven mechanical steering which has contributed greatly to its overall handling.



Further improvements have been made on deck with the addition of non-slip surfaces, plus far stronger and heavier deck fittings.

We really think you'll like this boat as we believe it has everything you could expect from a four berth cruiser, and more! Please let us know if we've left anything out — because this boat is built for you!

\*For full details of all standard fittings please consult current price leaflet.



# Viking Mouldings

