

Viking 24

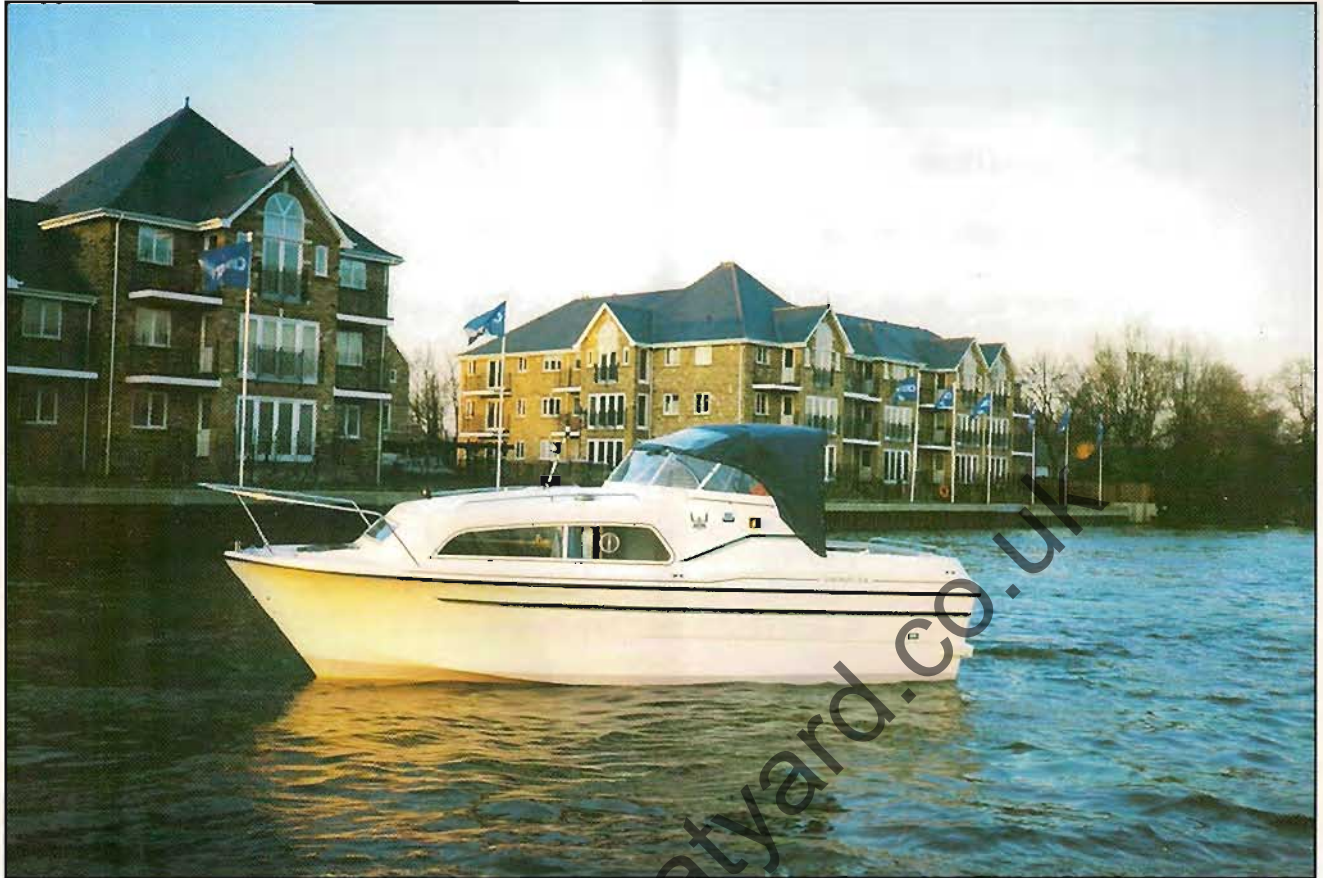

The latest addition to the Viking range features a high level of specification, combined with a wide beam to give extra stability and spacious accommodation.



A very modern and comfortable layout affords four full size adult berths and a superb cockpit for entertaining friends and family.



Viking Cruisers Ltd.

Upton Marina, Upton-upon-Severn, Worcester WR8 0PB

Tel: [++44] (0) 1684 594699 Fax: [++44] (0) 1684 593325



Viking 24

Dimensions:

Length, Longueur, Länge:	7.3m	24'0"
Beam, Largeur, Breite:	2.4m	8'0"
Draft, Tirant d'eau, Tiefgang:	0.5m	1'6"
Height above waterline:	2.2m to Screen	7'3" (approx.)

Cabin Headroom: 1.9m approx. 6'2" approx.

Berths: Four in large double forward and large undercab double berth (plus two in cockpit sunbed).

Weight: (ex-engine) 1,600kg

Construction: G.R.P. Hull form "Displacement"

Maximum engine size: 75hp (60Kw). Outboard in longshaft model or inboard sterndrive.

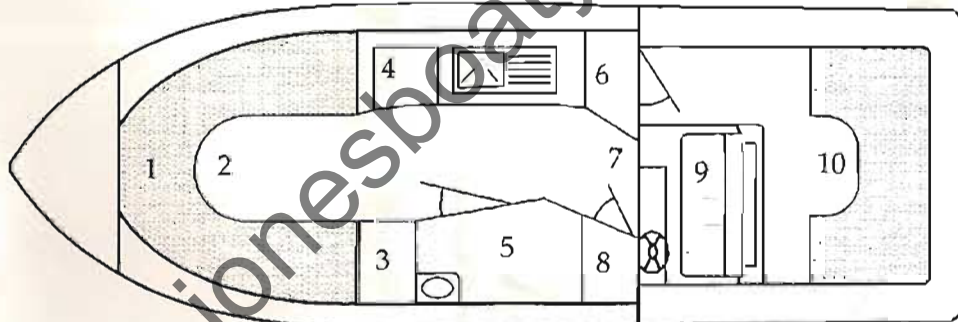

Drawn by David A. Fuller

Equipment fitted to hull as standard (see your dealer for full package details)

1. Double berth/Dinette
2. Table/Berth in-fill
3. Refrigerator
4. Fully fitted galley with two burner hob, grill, oven, pressurised hot and cold water system, stowage for stores and utensils
5. Toilet compartment with shower and washbasin
6. Step to main cabin
7. Entrance to double undercab berth
8. Wardrobe
9. Helm seat (seats two)
10. Cockpit seating area (converts to double berth)

We reserve the right to alter specification, E&OE

Viking Cruisers Ltd.

Upton Marina
Upton-upon-Severn,
Worcester WR8 0PB
Tel: [++44] (0) 1684 594699
Fax: [++44] (0) 1684 593325